



**X10c** (EA/SA/INTA) / **X4c** (EA/SA/INTA)

Installation of permanent water connection

- i** Before the JURA service technician can correctly put the X10c/X4c into operation in situ, certain preparations are necessary **on site**. The following preparations must be carried out **professionally** (in accordance with European standard EN 1717).

## Overview: On-site requirements and installation instructions

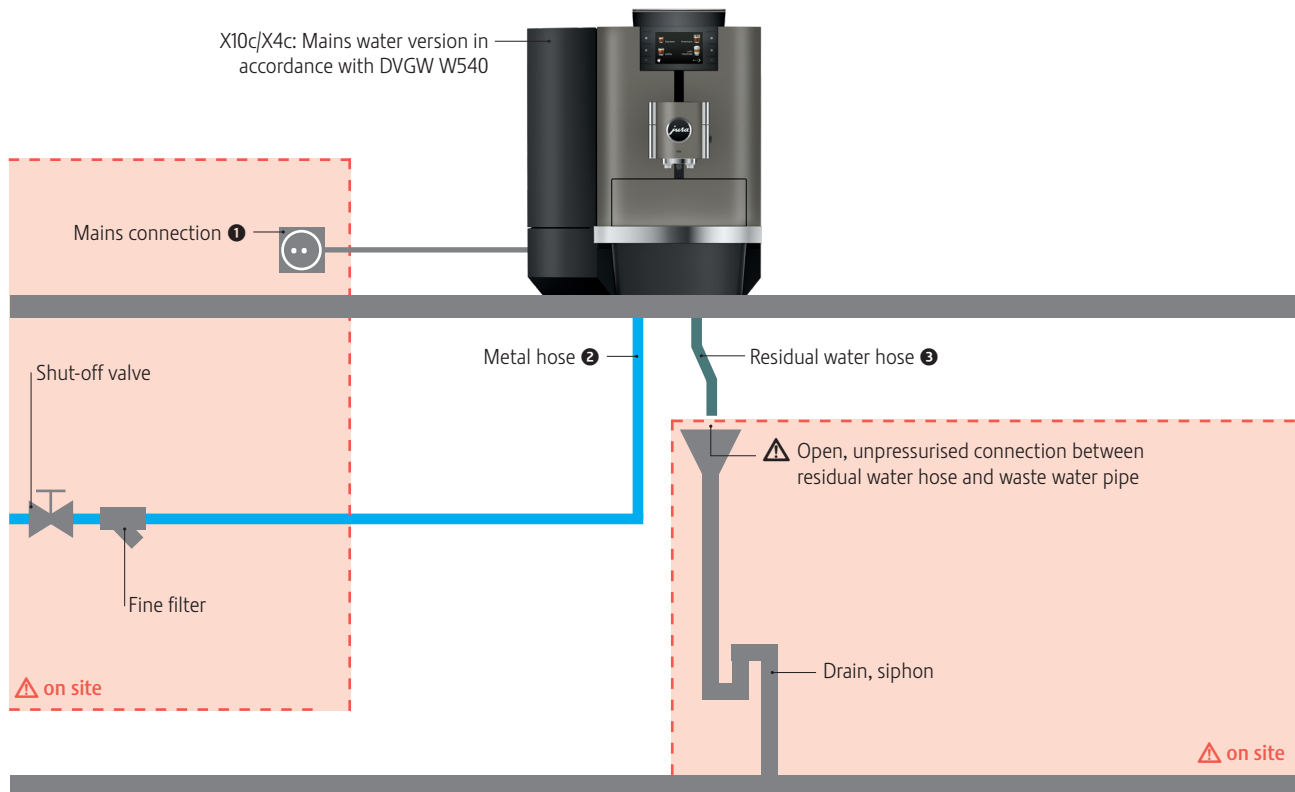

### Mains connection

- ①
  - The mains connection must be protected by a residual current device (RCD).
  - It must be possible to interrupt the power supply using a main switch.

### On-site permanent water connection (external thread G 3/8")

- ②
  - Must have a stopcock and filter
  - Water pressure from local network: max. 10 bar

### Residual water hose and drain

- ③
  - Use of the residual water hose supplied is expressly recommended!
  - The hose should be installed as short as possible and with the maximum possible inclination (in the fall line).
  - During installation, avoid a counter-inclination of the hose or the formation of a siphon in the residual water hose.
  - It must be possible to ventilate and evacuate air from the hose. This is achieved by an open, unpressurised connection between the residual water hose and the waste water pipe.
  - There should be a siphon in the waste water pipe installed on site.

## Installation of permanent water connection

### Fitting the residual water hose

- Remove the drip tray.
- Carefully lay the X10c/X4c on its side.
- Press the residual water hose into the recess on the underside of the appliance. The two clips (○) engage audibly.



- Stand the X10c/X4c up again.

### Prepare and connect the metal hose

- i** Depending on the nature of the installation site, the metal hose can be used in both directions. In the following example, the straight end is fitted to the X10c/X4c.

- Insert the blue sealing ring.

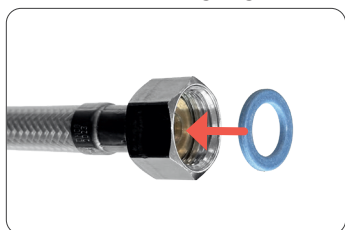

- Remove the yellow protective cap from the permanent water connection of the X10c/X4c.
- Screw the hose onto the permanent water connection. CAUTION! Do not overtighten the thread.



- Insert the filter.

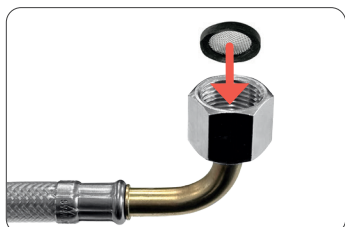

- Screw the hose onto the on-site permanent water connection.